



**PRIME
RESIDENCIES**

PRIME LANDS RESIDENCIES (PVT) LTD
#75, D. S. SENANAYAKE MAWATHA, COLOMBO 08

MONTHLY PROGRESS REPORT

PROPOSED APARTMENTS BUILDING AT 64, WARD PLACE, COLOMBO
– 07.

MONTH/YEAR – OCTOBER/2019
DOCUMENT NUMBER - PLR-MPR-WP-2019-10



PRIME GRAND
WARD PLACE

1.0 PROJECT DETAILS

- PROJECT

NAME & ADDRESS : Prime Grand – No 64, Ward Place, Colombo 07
COMMENCED : 6th December 2016

- CONSULTANTS

PROJECT ARCHITECT : The Design Group Five International (Pvt) Ltd.
STRUCTURAL ENGINEER : Civil & Structural Engineering Consultants (Pvt) Ltd.
MEP ENGINEER : The Design Group Five International (Pvt) Ltd.

- CONTRACTOR

PILING CONTRACTOR : D P Jayasinghe Piling (Pvt) Ltd.
CIVIL CONTRACTOR : MAGA Engineering (Pvt) Ltd.



FIGURE 1.1: PROPOSED APARTMENTS BUILDING AT NO.64, WARD PLACE COLOMBO - 07

2.0 WORK DONE UP TO THIS MONTH

TABLE 2. 1: PERCENTAGE OF ACTIVITY PROGRESS

Item No.	Description	Work Done Cumulative (%)
1.0	Construction of piles & Testing	100%
	Structural Works	
1.1	Sub- Structure Work (Pile caps & LGF)	100%
1.2	Super Structure Work (Concrete work)	80%
1.2.1	Lower Ground floor	100%
1.2.2	Ground floor	100%
1.2.3	Mezzanine floor	100%
1.2.4	1 st Floor to 4 th Floor	100%
1.2.5	Fifth floor (Podium Level)	100%
1.2.6	6 th Floor (Transfer floor)	100%
1.2.7	7 th Floor to 26 th Floor	100%
1.2.8	27 th Floor (Transfer floor)	100%
1.2.9	28 th Floor to 29 th Floor	100%
1.2.10	30 th Floor	59%
1.2.10.1	Reinforcement work for shear walls from 29 th to 30 th floor	80%
1.2.10.2	Formwork for shear walls from 29 th to 30 th floor	75%
1.2.10.3	Formwork for 30 th floor slab	65%
1.2.10.4	Reinforcement work for 30 th floor slab	50%
1.2.10.5	Concreting work of structural elements from 29 th floor to 30 th floor	40%
2.0	Finishing Works (Internal)	
2.1	Wall Finishes	
2.1.1	Lower Ground	40%
2.1.2	Ground Floor	65%
2.1.3	Mezzanine Floor	80%
2.1.4	1 st Floor – 4 th Floor	80%
2.1.5	5 th Floor (Podium Floor)	-
2.1.6	6 th Floor to 10 th Floor	85%
2.1.7	11 th Floor to 15 th Floor	70%
2.1.8	16 th Floor to 20 th Floor	60%
2.1.9	21 st Floor to 25 th Floor	45%
2.2	Ceiling finishes	
2.2.1	Lower Ground	-
2.2.2	Ground Floor	-

MONTHLY PROGRESS REPORT

OCTOBER/2019

2.2.3	Mezzanine Floor	85%
2.2.4	First Floor	85%
2.2.5	Second floor	85%
2.2.6	Third floor	85%
2.2.7	Fourth floor	50%
2.2.8	5 th Floor (Podium Floor)	-
2.2.9	6 th Floor	10%
2.2.10	7 th Floor	10%
3.0	Electrical Works	
3.1	Lightening protection work	80%
3.2	1 st Fix (Embedded items)	77%
3.3	2 nd Fix Items	14%
4.1	1 st Fix (Embedded items)	77%
4.2	2 nd Fix Items	9%
5.0	Mechanical Works (HVAC)	
5.1	1 st Fix (Embedded items)	77%
5.2	2 nd Fix items	2%
6.0	Gas System	
6.1	1 st Fix (Embedded items)	76%
6.2	Gas Supply system 2 nd Fix Items	25%
6.3	Gas Detection system 2 nd Fix items	8%
7.0	Fire Detection & Protection System	
7.1	Fire protection system 1 st Fix (Embedded items)	77%
7.2	Fire protection system 2 nd Fix items	21%
7.3	Fire detection system 1 st Fix (Embedded items)	77%
7.4	Fire detection system 2 nd Fix items	16%
8.0	ELV System	
8.1	1 st Fix (Embedded items)	77%
8.2	2 nd Fix Items	17%

3.0 SITE PHOTOS



Figure 3.1 - Site View



Figure 3.2 – Formwork for slab 30th floor



Figure 3.3 – Aluminum doors and windows testing in International Laboratory - Dubai



Figure 3.4 – Aluminum doors and windows testing in International Laboratory - Dubai



Figure 3.5 – Reinforcement and formwork for staircase (29th floor to 30th floor)



Figure 3.6 – Masonry walls (25th floor)



Figure 3.7 – Ceiling works of mock up apartment (7th floor)



Figure 3.8 – Podium floor kids swimming pool reinforcement work

4.0 SITE PROGRESS

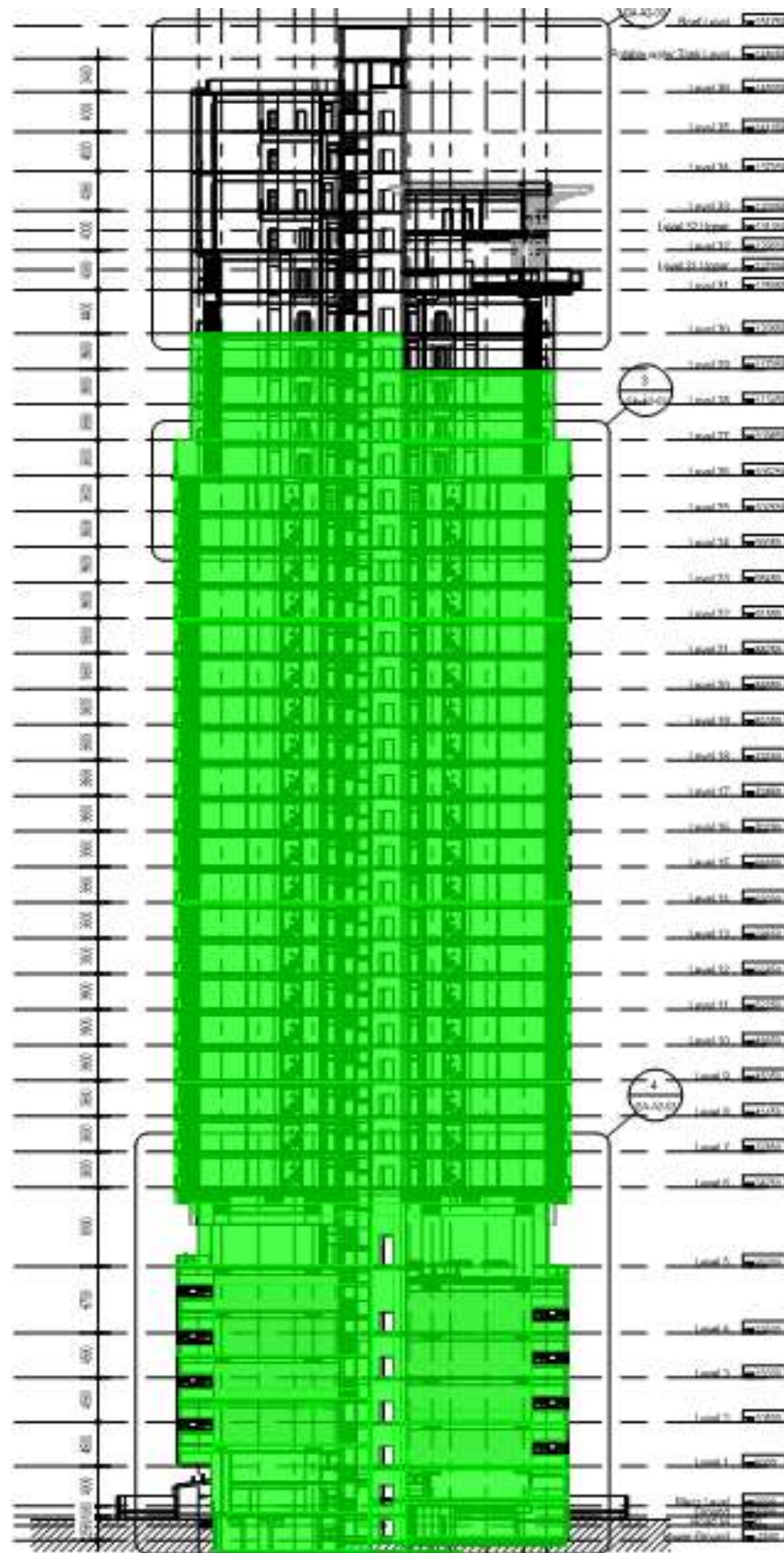

FIGURE 4.1: SUPERSTRUCUTRE PROGRESS (Concrete works)